

Bushfire policy

Mount Barker Kindergarten will be closed on the day of a catastrophic fire weather forecast.

Parents will be contacted by SMS, email (where appropriate), sign on the gate and/or notes sent home to advise of the kindergarten closure.

Please familiarise yourself with the “fire danger season parent brochure” for detailed information about how Mount Barker Kindergarten and Primary School are working together for bush fire survival. The brochure will be given out twice a year (term 4 and term 1) to all families before the declared bushfire season.

Parents must become familiar with the CFS information and warning system, which keeps the community informed about bushfires. On high to extreme bush fire days, you should listen to ABC radio and 5AA/NOVA, which are the official bushfire information and warning stations. For more information about the bushfire information system go to www.cfs.sa.gov.au. Please place this notice in a prominent position, eg on your fridge.

Bushfire season can be an anxious time for children and families. Our kindergarten is in a “high risk” bushfire area so the following emergency plans are to ensure the safety of everybody in the event of a bushfire.

Evacuation drills

In the first two weeks of terms 1 and 4, staff and children will practice the emergency evacuation procedure.

‘Catastrophic’ (code red) fire danger days

A sign advising the kindergarten families will be placed by the front gate. The kindergarten will be closed. No sessions will be offered and all staff will remain off site.

A message will be sent to families via mobile phone text reminding them of the closure.

‘Total fire ban’ and ‘extreme fire danger’

- The kindergarten will offer normal sessions.
- A notice will be displayed on the front gate.
- Children will be required to wear shoes all day in case of evacuation.
- The radio will be tuned on to the ABC and staff will monitor the CFS website.
- Staff will be alert to signs in the immediate area and report to other staff, eg smoke, high winds, sirens, reports on the radio and web site.
- Staff will ensure the first aid kit and medical conditions box are ready to take in case of evacuation.

Fire reported in the district

Staff will advise the regional office and liaise with Mt Barker Primary School and the local CFS.

Staff responsibilities

- One staff member will ring bell to gather all children inside.
- Prepare the sprinkler system and collect a fire extinguisher to take with us.
- Outside and inside staff to do a sweep of the kindergarten to ensure all children are gathered together.

- Staff will then advise children of the situation and prepare to evacuate to the school safe refuge hall.
- Staff will then call the roll to ensure all children are accounted for.

Bushfire in immediate vicinity

- Assemble children to playhouse gate or main gate, depending on the direction and location of fire.
- Staff to collect roll book with all emergency contact information.
- Do a head count and call the roll.
- Turn on sprinkler system (control in children's bathroom) and outside bushfire sprinkler (handle above outside tap).
- ECW to take first aid, individual health care plans (medical box) and satellite/mobile phone.
- Move children and staff to school safe refuge hall.
- Roll call again.
- All children to remain in hall until situation is assessed as safe by emergency services.

Evacuation diagram

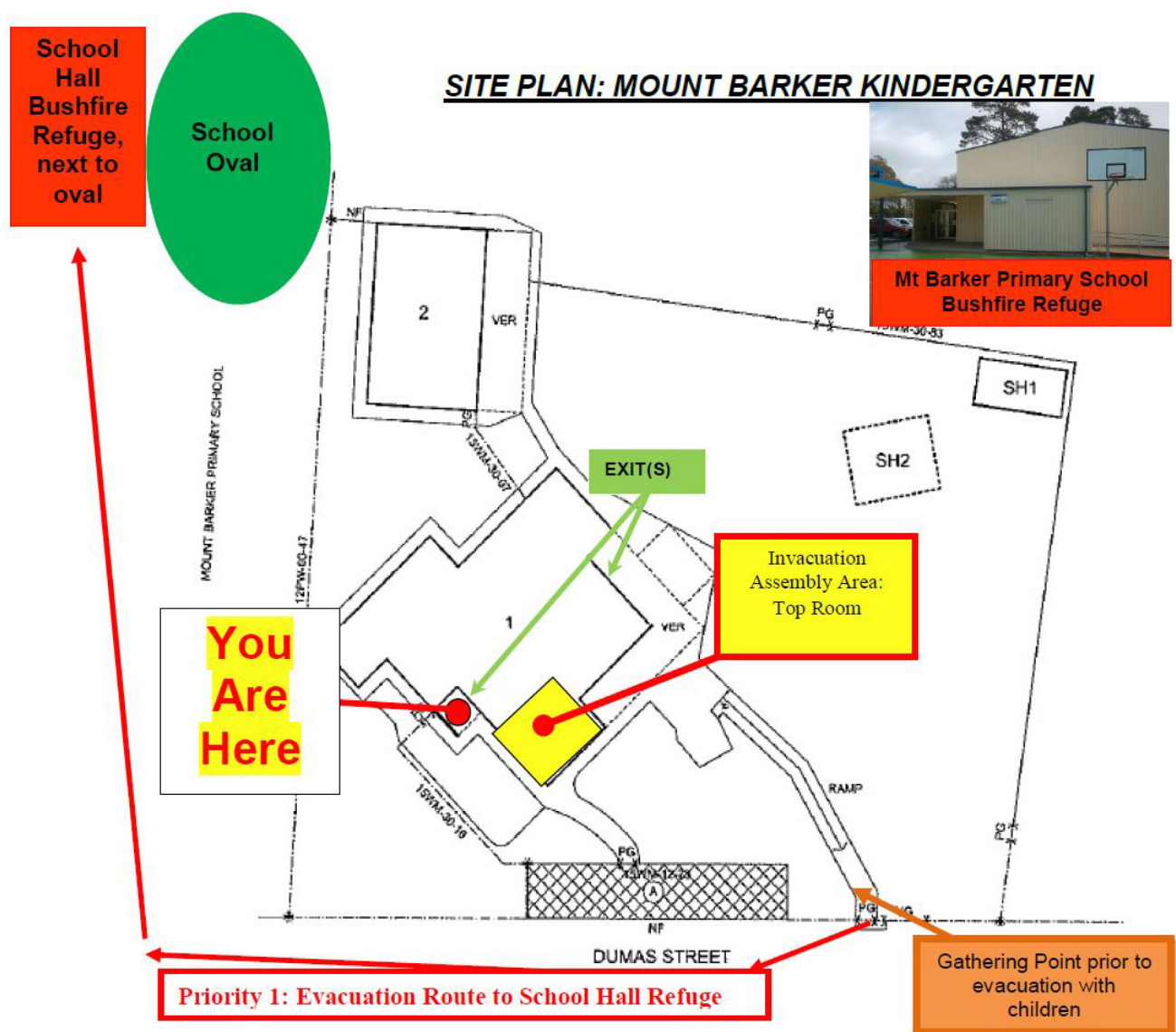

Approaching bushfire

If our school or preschool is open and a bushfire is approaching, the safety of children is our highest priority.

Our school or preschool's designated bushfire refuge is the safest place for us to be if a bushfire is approaching and this is why schools are not evacuated unless there is no other option or as advised by CFS.

When we move to our bushfire refuge we activate the following emergency procedures:

- moving everybody inside, closing windows, doors, and turning off the air-conditioning
- filling available containers with water
- if it is safe to do so and time permits, turning on all sprinklers and irrigation systems
- remaining inside and enacting our bushfire response plan with the children until the main fire-front passes

- listening to local ABC radio station and 5AA radio stations for bushfire updates and information
- liaise with the DECD bushfire and emergency management team and the CFS to know when the bushfire is approaching and changing conditions.

We hope that we will never have to enact our bushfire response plan. However we are working with out school and preschool communities to be ready in the event of a bushfire emergency and trust that as parents and carers we will have your support.

Please see also the emergency management document.